



SugarHouse Industries
 7526 S. State Street
 Midvale, UT 84047
 801-563-9600 / 801-563-9606 Fax



278861
Sales Order
 Number: 278861

Date: Mar 5, 2026 05:33 AM

Billing Address	Install / Ship To Address	Additional Info
Dennis Ferguson 75 N U Street Salt Lake City, UT 84103 (801) 209-8094 dferguson@fergusonmediation.com		Dennis Ferguson - - 12. Awnings - Awning - Put Up Salesman: Project Coordination Team Method: AWN Put Up Lead Time: Finish Date: Original item here: Yes/No Return / Toss Original: Yes/No

Package Dimensions	Package Weight	P/U Loc	Department	Ready to Close
UPS Estimates	UPS Actual	Terms	Inspect	Deposit
			4/29/26 TOMY	

Product / Description	Price	Qty	Total
-----------------------	-------	-----	-------

Awning - Put Up
 Put Up: (1) Patio Canopy
 Color: Gray
 Stored Here Shelf #9 in storage container
 Needs an Appointment: No
 Needs to be there: No

2025(2) 1.75 \$ 295
 2024(2) 1.84 \$ 289
 2023(2) 1.34 \$ 279
 2022(2) 1.75 \$ 279

Sub Total \$ 299.00
 Tax
 Shipping
 Grand Total \$ 299.00
 Deposit Paid
 Balance Due

Terms and Conditions

- ALL WORK IS GUARANTEED against defects in materials and workmanship for 90 days after delivery. Some items and materials may have longer warranties. Ask your sales person for those details and warranties.
- CHANGES in the above order will only be made after customer approval of any changes, including any related additional costs.
- FULL PAYMENT is due upon delivery.
- RETURNED CHECK charge is \$20.00 plus costs of collection.
- PAYMENT AND PRE-PAYMENTS are non-refundable. No returns on custom orders.
- WE CLAIM A LIEN on all property until services are paid in full, and may retain possession of any property upon which we have performed labor until full payment, including interest and storage charges have been made.
- STORAGE FEES may be charged for any property not claimed and paid for within 30 days after completion of work.
- PROPERTY MAY BE SOLD IF not claimed within 45 days, or if it is held by us more than 45 days due to customers failure to pay all amounts due. Proceeds will be applied to amounts due. We retain the right after sale to sue for any remaining amounts owed.
- COLLECTION COSTS: I agree to pay all attorney's fees, court costs, filing fees and collection costs. Up to 50% of the amount owing may be added as a cost of collection.

We fence and lock our storage lot, but we are not responsible for losses due to fire, theft or other causes not directly attributable to actions of our employees. You are responsible for appropriate insurance against loss or damage to your property.
 Customer Initials _____
 I have read and received a copy of:
 Upholstery Discoloration Disclaimer
<https://sugarhouse.us/discoloration-disclaimer/>
 Customer Initials _____
 Care and Use Instructions and Warranty information.
 Customer Initials _____

CUSTOMER ACCEPTANCE OF ORDER AND TERMS MERCHANDISE RECEIVED BY DATE



4/28/26 TONY & SPENDER
PIU (1) HALL-ON CANOPY

(F	DRIVE	.10
	PIU	<u>1.25</u>
	TOT	<u>1.35</u>

1.35
x2
<u>2.70</u>



SugarHouse Industries
 7526 S. State Street
 Midvale, UT 84047
 801-563-9600 800-657-6394 801-563-9606 Fax

Sales Order
 Number: 274761
 Date: Apr 17, 2025 03:50 PM

Billing Address	Install / Ship To Address	Additional Info
Dennis Ferguson 75 U St Salt Lake, UT 84103 801-209-8094 dferguson@fergusonmediation.com		Dennis Ferguson - - 12. Awnings - Awning - Put Up Salesman: Project Coordination Team Method: AWN Put Up Lead Time: Finish Date: Original item here: Yes/No Return / Toss Original: Yes/No

Package Dimensions	Package Weight	P/U Loc	Department	Ready to Close
UPS Estimates	UPS Actual	Terms	Inspect	Deposit

Product / Description	Price	Qty	Total
Awning - Put Up Put Up: (1) Patio Canopy Stored: Here - shelf 4 Color: Grey			\$ 295.00

Needs an Appointment: No
 Needs to be there: No

SHOP COPY

Sub Total	\$ 295.00
Tax	-
Shipping	-
Grand Total	\$ 295.00
Deposit Paid	
Balance Due	

2024 (2) 1.83 \$ 289.
 2023 (2) 1.34 \$ 279
 2022 (2) 1.75 \$ 279
 2021 (2) 1.58 \$ 250

Terms and Conditions

- ALL WORK IS GUARANTEED against defects in materials and workmanship for 90 days after delivery. Some items and materials may have longer warranties. Ask your sales person for those details and warranties.
- CHANGES in the above order will only be made after customer approval of any changes, including any related additional costs.
- FULL PAYMENT is due upon delivery.
- RETURNED CHECK charge is \$20.00 plus costs of collection.
- PAYMENT AND PRE-PAYMENTS are non-refundable. No returns on custom orders.
- WE CLAIM A LIEN on all property until services are paid in full, and may retain possession of any property upon which we have performed labor until full payment, including interest and storage charges have been made.
- STORAGE FEES may be charged for any property not claimed and paid for within 30 days after completion of work.
- PROPERTY MAY BE SOLD IF not claimed within 45 days, or if it is held by us more than 45 days due to customers failure to pay all amounts due. Proceeds will be applied to amounts due. We retain the right after sale to sue for any remaining amounts owed.
- COLLECTION COSTS: I agree to pay all attorney's fees, court costs, filing fees and collection costs. Up to 50% of the amount owing may be added as a cost of collection.

We fence and lock our storage lot, but we are not responsible for losses due to fire, theft or other causes not directly attributable to actions of our employees. You are responsible for appropriate insurance against loss or damage to your property.

I have read and received a copy of:

Upholstery Discoloration Disclaimer
<https://sugarhouse.us/discoloration-disclaimer/>

Care and Use Instructions and Warranty information.

 Customer Initials

 Customer Initials

 Customer Initials

CUSTOMER ACCEPTANCE OF ORDER AND TERMS

MERCHANDISE RECEIVED BY

DATE

5-1-25 Chad & Spencer

P/y 1 canopy.

Drive	<u>0.09</u>
Work	<u>1.75</u>
Total	<u>1.84</u>



SugarHouse Industries
 7526 S. State Street
 Midvale, UT 84047
 801-563-9600 / 801-563-9606 Fax



276939
Sales Order
 Number: 276939

Date: Aug 27, 2025 10:47 AM

Billing Address	Install / Ship To Address	Additional Info
Dennis Ferguson 75 U St Salt Lake, UT 84103 801-209-8094 dferguson@fergusonmediation.com		Dennis Ferguson - - 12. Awnings - Awning - Takedown Salesman: Project Coordination Team Method: AWN Takedown Lead Time: Finish Date: Original item here: Yes/No Return / Toss Original: Yes/No

Package Dimensions	Package Weight	P/U Loc	Department	Ready to Close
UPS Estimates	UPS Actual	Terms	Inspect	Deposit
			10/23/25 TOMY	
				12. Awnings
				CB 10/27/25
				Paid/Billed

Product / Description	Price	Qty	Total
Awning - Takedown Take Down (1) Patio Canopy Store: Her Needs Appointment: No Needs to be there: No Clean and Treat Estimate: No Repair Estimate: No Color: Grey		1	\$193.00
Awning - Storage Storage fee for takedown products		1	\$65.00
Sub Total			\$258.00
Tax			
Shipping			
Grand Total			\$258.00
Deposit Paid			
Balance Due			

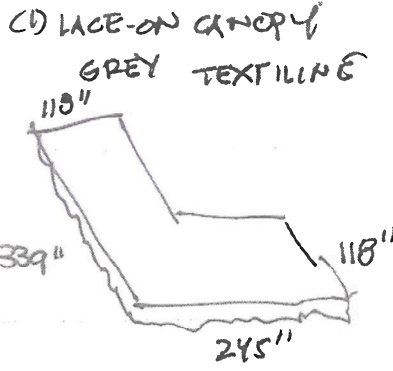

2024 (2) .67 \$183 + \$65
 2023 (2) .58 \$173 + \$65
 2022 (2) .75 \$170 + \$65
 2021 (2) .58 \$150 + \$35

Terms and Conditions

- ALL WORK IS GUARANTEED against defects in materials and workmanship for 90 days after delivery. Some items and materials may have longer warranties. Ask your sales person for those details and warranties.
- CHANGES in the above order will only be made after customer approval of any changes, including any related additional costs.
- FULL PAYMENT is due upon delivery.
- RETURNED CHECK charge is \$20.00 plus costs of collection.
- PAYMENT AND PRE-PAYMENTS are non-refundable. No returns on custom orders.
- WE CLAIM A LIEN on all property until services are paid in full, and may retain possession of any property upon which we have performed labor until full payment, including interest and storage charges have been made.
- STORAGE FEES may be charged for any property not claimed and paid for within 30 days after completion of work.
- PROPERTY MAY BE SOLD IF not claimed within 45 days, or if it is held by us more than 45 days due to customers failure to pay all amounts due. Proceeds will be applied to amounts due. We retain the right after sale to sue for any remaining amounts owed.
- COLLECTION COSTS: I agree to pay all attorney's fees, court costs, filing fees and collection costs. Up to 50% of the amount owing may be added as a cost of collection.

We fence and lock our storage lot, but we are not responsible for losses due to fire, theft or other causes not directly attributable to actions of our employees. You are responsible for appropriate insurance against loss or damage to your property.

I have read and received a copy of:
 Upholstery Discoloration Disclaimer
<https://sugarhouse.us/discoloration-disclaimer/>
 Care and Use Instructions and Warranty information.

Customer Initials _____
 Customer Initials _____
 Customer Initials _____

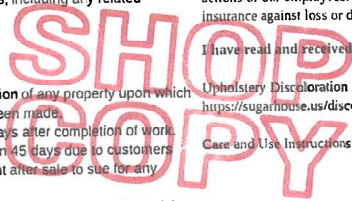

TW
 10/21 WJM+text kg
 10/10 LVM SP

CUSTOMER ACCEPTANCE OF ORDER AND TERMS MERCHANDISE RECEIVED BY DATE

~~XXXXXXXXXX~~

10/23/25 Tony & Henry

T/O (D) LACE-ON CANOPY. STRUCTURE
STAYS "UP" & HEADRODS IN CLAMPS
COVER STORES "HERE"

(F	DRIVE	.06
	T/O	.67
	TOT	.73

$$\begin{array}{r} .73 \\ \times 2 \\ \hline 1.46 \end{array}$$

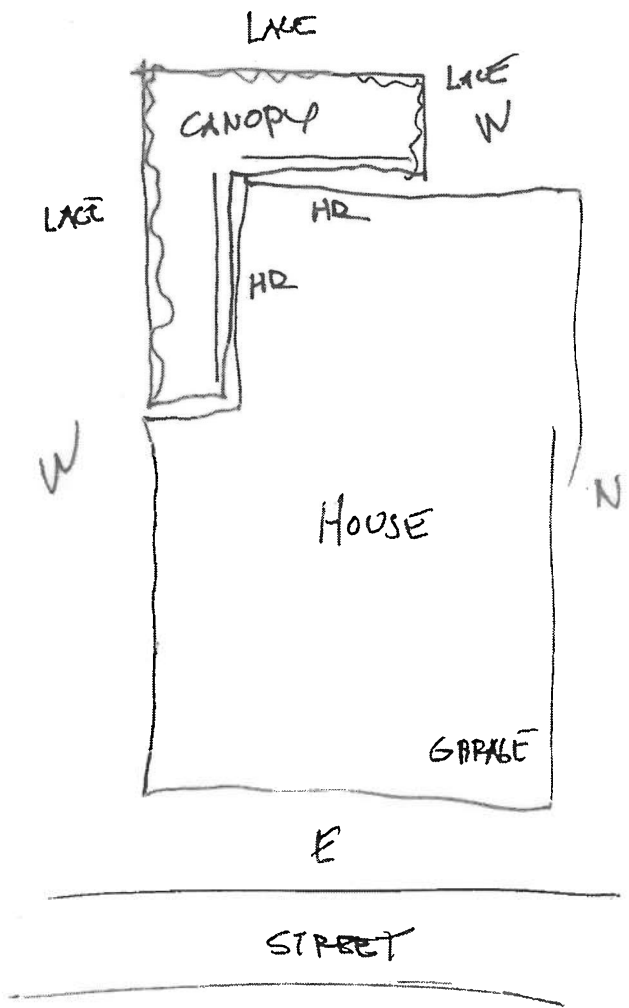

Customer Name: Dennis Ferguson SO #: 276939

Date: 10/23

Rope Verticools

Location(s) Stored: _____ Color(s): _____

Fabric: Sunbrella Textilene

Size of Shades:

- 1. _____ 2. _____ 3. _____ 4. _____ 5. _____
- 6. _____ 7. _____ 8. _____ 9. _____ 10. _____

Cleaning Recommended? Yes No Mold/Mildew Urgent

Condition of Fabric: Great Good Fair Needs to be replaced

Repair Recommended? Yes No

Description of Repairs:

GOLF

Photos Uploaded in Workiz

Patio Canopies

Location(s) Stored: "HERE" SHELF #9 IN STORAGE CONTAINER Color(s): Canopy

Fabric: Sunbrella TEXTILINE

Size of Canopies:

- 1. 339 X 245 X 118 2. _____ 3. _____ 4. _____ 5. _____

Cleaning Recommended? Yes No Mold/Mildew Urgent

Condition of Fabric: Great Good Fair Needs to be replaced

Repair Recommended? Yes No

Description of Repairs:

Photos Uploaded in Workiz

Customer Name: _____ SO #: _____

Date: _____

Shade Glides, Sun Tamers, and Rayblocks

Location(s) Stored: _____ Color(s): _____

Fabric: Sunbrella Textilene (Only applies to Shade Glides and Sun Tamers)

Size of Shades:

1. _____ 2. _____ 3. _____ 4. _____ 5. _____

6. _____ 7. _____ 8. _____ 9. _____ 10. _____

Clearing Recommended? Yes No Mold/Mildew Urgent

Condition of Fabric: Great Good Fair Needs to be replaced

Repair Recommended? Yes No

Description of Repairs:

Photos Uploaded in Workiz

Misc: _____

Location(s) Stored: _____ Color(s): _____

Fabric: Sunbrella Textilene TX Other _____

Size of Shades:

1. _____ 2. _____ 3. _____ 4. _____ 5. _____

Cleaning Recommended? Yes No Mold/Mildew Urgent

Condition of Fabric: Great Good Fair Needs to be replaced

Repair Recommended? Yes No

Description of Repairs:

Photos Uploaded in Workiz

